



HDS 5/12 C

Unique eco!efficiency mode, simple one-button operation, integrated tanks, on-board practical hose/cable storage, accessory compartment, large wheels and swivel castor - welcome to the hot water compact class!



1 Efficiency

- eco!efficiency mode – economical and environmentally friendly, even during longer periods of use.
- Reduces fuel consumption and CO2 emissions by 20%.

2 Ease of use

- Intuitive operation with large single-button selector switch.
- Large tank opening with filling chute.

3 Storage

- Lockable accessory compartment for nozzles, tools, etc.
- Storage hooks for power cord and high-pressure hose.

4 Mobility

- Jogger principle with large wheels and steering roller.
- Large integrated handles in the chassis.



HDS 5/12 C

■ Economical ecoefficiency mode

Technical data

Order Number	1.272-902.0	
EAN code	4054278168845	
Current type	Ph / V / Hz	1 / 240 / 50
Flow rate	l/h	500
Pressure	bar / MPa	120 / 12
Max. temperature	°C	80
Power rating	kW	2,9
Consumption fuel oil	kg/h	3,2
Fuel tank	l	15
Weight	kg	93,4
Dimensions (L x W x H)	mm	1060 × 650 × 920

Equipment

Trigger gun	EASY!Force Advanced	
High-pressure hose	m	10 / ID 6, 250 bar
Spray lance	mm	840
SDS system	■	
ANTI!Twist	■	
Pressure switch control	■	
Integral fuel and detergent tank	■	
Servo Control	-	

■ Included in delivery.

HDS 5/12 C

1.272-902.0

KÄRCHER



		Order Number	ID	Max. working pressure	Length	Price	Description	
Standard with unions on both sides								
High-pressure hose, 10 m DN 8, AVS trigger gun connector	1	6.110-031.0	ID 8	315 bar	10 m		10 m high-pressure hose (M 22 x 1.5) with kink protection. With patented rotating AVS trigger gun connector and manual coupling. Further data: DN 8/155°C/315 bar.	▲
High-pressure hose, 15 m DN 8, AVS trigger gun connector	2	6.110-030.0	ID 8	315 bar	15 m		15 m high-pressure hose (M 22 x 1.5) with kink protection. With patented rotating AVS trigger gun connector and manual coupling. Further data: DN 8/155°C/315 bar.	▲
High-pressure hose, 20 m DN 8, AVS trigger gun connector	3	6.110-032.0	ID 8	315 bar	20 m		20 m high-pressure hose (M 22 x 1.5) with kink protection. With patented rotating AVS trigger gun connector and manual coupling. Further data: DN 8/155°C/315 bar.	▲
High-pressure hose, 30 m DN 8, including rotary coupling	4	6.110-014.0	ID 8	315 bar	30 m		With rotary coupling, 2 x M 22 x 1.5	▲
High-pressure hose, 15 m DN 10, 220 bar, extension	5	6.110-042.0	ID 10	220 bar	15 m		15 m high-pressure hose M 22 x 1.5) with kink protection and threaded couplings at both ends. Further data: DN 10/155°C/220 bar.	▲
High-pressure hose, 20 m DN 10, 220 bar, extension	6	6.110-043.0	ID 10	220 bar	20 m		with union on both sides, M 22 x 1.5 with anti-kink protection. NW 10/155°C/220 bar	▲
High-pressure hose, 25 m DN 10, extension, not rotatable	7	6.110-044.0	ID 10	220 bar	25 m			▲
Hose assembly premium DN10 22MPa 40m	8	6.110-045.0	ID 10	220 bar	40 m			▲
Hose assembly premium DN12 21MPa 15m	9	6.110-059.0	ID 12	210 bar	15 m		High-pressure hose for water volumes greater than 1,800 l/h. With union on both sides. 2x M 22 x 1.5 with anti-kink protection.	▲
Hose assembly premium DN12 21MPa 40m	10	6.110-060.0	ID 12	210 bar	40 m			▲
Hose assembly TR DN10 22MPa 10m	11	6.110-041.0	ID 10	220 bar	10 m			▲
High-pressure hose, 10 m DN 6, AVS trigger gun connector	12	6.110-034.0	ID 6	250 bar	10 m		10 m high-pressure hose (M 22 x 1.5) with kink protection.	■
	13	6.110-035.0	ID 6	250 bar	10 m		With patented rotating AVS trigger gun connector and manual coupling. Further data: DN 6/155°C/250 bar.	□
High-pressure hose, 10 m, DN 6, 300 bar, AVS trigger gun connection	14	6.110-056.0	ID 6	300 bar	10 m		With patented AVS connection in the trigger gun (pivot-mounted) and hand screw union. M 22 x 1.5 with anti-kink protection. NW 6/155°C/300 bar	□
Longlife 400 with unions on both sides								
High-pressure hose Longlife 400, 30 m DN 8, including rotary coupling	15	6.110-023.0	ID 8	400 bar	30 m		With rotary coupling, 2 x M 22 x 1.5	▲
High-pressure hose Longlife 400, 20 m, DN 8, extension	16	6.110-027.0	ID 8	400 bar	20 m		with rotary coupling, 2 x M 22 x 1.5	▲
High-pressure hose Longlife 400, 15 m, DN 8, including rotary coupling	17	6.110-029.0	ID 8	400 bar	15 m		With rotary coupling, 2 x M 22 x 1.5	▲
High-pressure hose 1.5 m, DN 8, including connectors	18	6.110-024.0	ID 8	400 bar	1.5 m		1.5 m high-pressure hose (DN 8, M 22 x 1.5) with kink protection and connectors at both ends. For connecting to hose reels with appropriate connector (M 22 x 1.5).	□
	19	6.110-069.0	ID 8	400 bar	1.5 m			□
Food industry version with unions on both sides								
High-pressure hose, 10 m ID 8, suitable for food industry, extension piece	20	6.110-051.0	ID 8	250 bar	10 m		10 m high-pressure hose (DN 8) with patented (rotating) AVS trigger gun connector. Non-discolouring outer layer for use in the food industry. M 22 x 1.5 with anti-kink sleeve.	▲

■ Included in delivery. □ Available accessories. ▲ Extension hose.

HDS 5/12 C

1.272-902.0

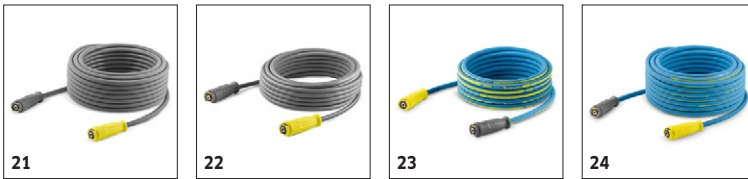

		Order Number	ID	Max. working pressure	Length		Price	Description	
High-pressure hose, 20 m ID 8, suitable for food industry, extension piece	21	6.110-052.0	ID 8	250 bar	20 m			20 m high-pressure hose (DN 8) with swivel coupling. Non-discolouring outer layer for use in the food industry. Connectors at both ends, M 22 x 1.5, with kink protection. NW 8/155°C/250 bar.	▲
High-pressure hose 15 m ID 6, AVS trigger gun connector 11 mm, suitable for food industry, grey	22	6.110-063.0	ID 6	250 bar	15 m			15 m high-pressure hose (DN 6) with patented (rotating) AVS trigger gun connector. Non-discolouring outer layer for use in the food industry. DN 6/155°C/250 bar.	□
Longlife food industry version with unions on both sides									
High pressure hose food DN 8 / 10 m	23	6.110-053.0	ID 8	400 bar	10 m			Longlife HP hose for use in the food industry. Außendecke## animal-grease-resistant, non-colour-bleeding material. With rotary coupling, 2 x M 22 x 1,5	▲
High-pressure hose Longlife 400, 15 m, ID 6, AVS trigger gun connection	24	6.110-054.0	ID 8	400 bar	20 m			Longlife HP hose for use in the food industry. Außendecke## animal-grease-resistant, non-colour-bleeding material. With patented AVS connection in the pistol (pivot mounted)	□

■ Included in delivery. □ Available accessories. ▲ Extension hose.

HDS 5/12 C

1.272-902.0



		Order Number	Flow rate				Price	Description	
Trigger guns									
EASY!Force Advanced	1	4.118-005.0						Effortless, not energy-sapping: the EASY!Force high-pressure gun uses the recoil force of the high-pressure jet to reduce the holding force for the operator to zero.	■
Quick connect									
Quick-fitting pipe union coupler trapezo	2	2.115-000.0							<input type="checkbox"/>
Quick-fitting pipe union plug nipple tra	3	2.115-001.0							<input type="checkbox"/>

■ Included in delivery. □ Available accessories. ▲ Extension hose.

HDS 5/12 C

1.272-902.0

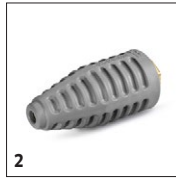

		Order Number	Max. working pressure	Nozzle size			Price	Description
Triple nozzles								
Triple nozzle 034	1	4.117-029.0	300 bar	34				Triple nozzle with manual nozzle changeover. Convenient spray adjustment. For high-pressure cleaners with injector; low-pressure fan jet for detergent removal and application. Connector M 18x1.5. <input checked="" type="checkbox"/>
Dirt blaster, large								
Dirt blaster - without changeover function	2	4.114-040.0	300 bar	35				The dirt blaster with rotating pencil jet offers 10 times better cleaning performance. Ceramic nozzle and bearing ring for a long service life. Further data: Max. 300 bar, 30 MPa, 85°C. <input type="checkbox"/>

Included in delivery.
 Available accessories.
 Extension hose.

HDS 5/12 C

1.272-902.0

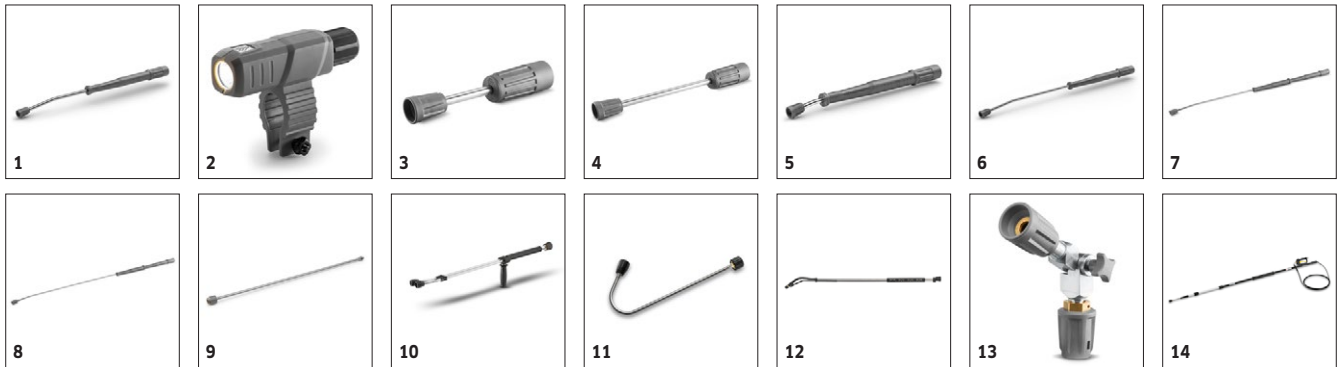

			Order Number	Max. working pressure	Length		Price	Description	
Rotating spray lances									
Lance 850 mm, rotatable, ergonomic	1		4.112-006.0	300 bar	840 mm			850 mm stainless steel lance (manual coupling) with ergonomic handle for ease of use and protection. Rotatable 360° under pressure.	■
Nozzle light	2		2.680-002.0		125 mm				□
Lance 250 mm, non-rotatable	3		4.112-027.0	300 bar	250 mm				□
550 mm lance, non-rotatable	4		4.112-024.0	300 bar	400 mm				□
Rotatable lance, 600 mm, ergonomic	5		4.112-007.0	300 bar	600 mm			600 mm stainless steel lance (manual coupling) with ergonomic handle for ease of use and protection. Rotatable 360° under pressure.	□
1050 mm lance, rotatable, ergonomic	6		4.112-000.0	300 bar	1050 mm			1050 mm stainless steel lance (manual coupling) with ergonomic handle for ease of use and protection. Rotatable 360° under pressure.	□
Lance 1550 mm, rotatable, ergonomic	7		4.112-018.0	300 bar	1550 mm			1550 mm stainless steel lance (manual coupling) with ergonomic handle for ease of use and protection. Rotatable 360° under pressure.	□
Lance 2050 mm, rotatable, ergonomic	8		4.112-021.0	300 bar	2050 mm			2050 mm stainless steel lance (manual coupling) with ergonomic handle for ease of use and protection. Rotatable 360° under pressure.	□
Jet pipe extension TR 1000 mm	9		4.112-048.0	300 bar	1000 mm				□
Double lance									
Double lance 960 mm	10		2.112-016.0	310 bar	960 mm			960 mm double lance for variable pressure adjustment on handle at full water flow rate. Suitable for agricultural use (e.g. stable cleaning).	□
Angular spray lance									
WC and gutter lance	11		4.112-029.0					Stainless steel lance WC and gutter with nozzle insert. Specially shaped for effective and hygienic cleaning of gutters and toilets.	□
Flexible spray lance									
Flexible lance 1050 mm	12		4.112-035.0	210 bar	1050 mm			1050 mm flexible lance with variable bend from 20° to 140°, ideal for cleaning difficult to reach areas, e.g. gutters.	□
Articulated joint TR 20	13		4.112-057.0	300 bar					□
Telescopic spray lance									
Telescopic jet pipe	14		4.112-037.0	225 bar	5400 mm				□
Restraint belt for telescopic jet pipe	15		6.373-987.0					Convenient strap for relief when working with the telescopic spray lance (6.394-690). The burden is optimally distributed on the body and longer periods of use are possible.	□
Gutter cleaner									
Gutter cleaning lance	16		2.112-015.0		960 mm			The lance is suited for cleaning of gutter systems. Because of the shape of the lance and the special nozzle the gutter can be cleaned without removing the cover plates.	□
Undercarriage spray lance									
Underbody lance	17		4.112-032.0		700 mm			Stainless steel lance for effective and easy underbody and wheel arch cleaning. Without high-pressure nozzle.	□
Additional handle									
	18		4.321-380.0						□
PowerControl spray lance									
Pressure regulating jet pipe packaged Po	19		4.112-045.0						□

■ Included in delivery. □ Available accessories. ▲ Extension hose.

HDS 5/12 C

1.272-902.0

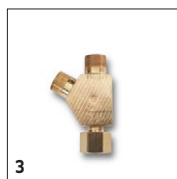

		Order Number					Price	Description	
Crane lifting kit									
Add-on kit suspension crane HDS C	1	2.642-638.0							<input type="checkbox"/>
Flame monitoring attachment kit									
ABS flame monitor for HDS C	2	2.642-711.0							<input type="checkbox"/>
Y distributor									
Y distributor	3	4.111-024.0							<input type="checkbox"/>

Included in delivery.
 Available accessories.
 Extension hose.

HDS 5/12 C

1.272-902.0

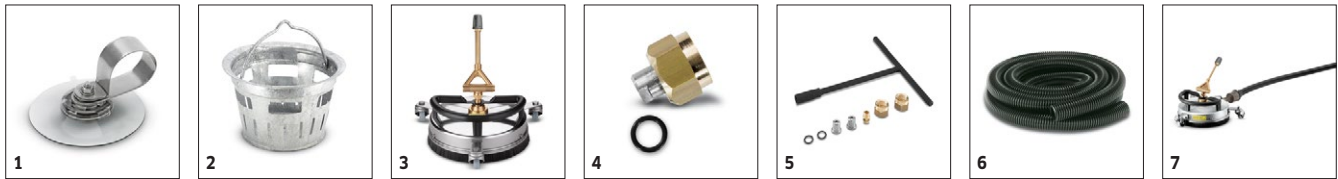

		Order Number	Flow rate	Nozzle size	Diame-ter	Price	Description	
Hard Surface Cleaner FRV 30								
Add-on kit hose attachment	1	2.642-528.0						<input type="checkbox"/>
Add-on kit dirt trap	2	2.642-532.0						<input type="checkbox"/>
Hard surface cleaner FR 30 ME								
FR 30 ME surface cleaner	3	2.111-013.0			300 mm		Hot water resistant stainless steel surface cleaner with double ceramic bearings, non-marking swivel castors and suction hose connection. Ideal for indoor cleaning, e.g. food industry.	<input type="checkbox"/>
Machine-specific nozzle kit for FR								
Nozzle kit for surface cleaners (type-specific) 450 - 500 l/h	4	2.640-482.0	450-500 l/h				Nozzle kit includes power nozzles and unions. For Kärcher surface cleaners (450 to 500 l/h).	<input type="checkbox"/>
Machine-specific nozzle kits for FRV								
Nozzle kit 035 for FRV 30	5	2.642-430.0		35				<input type="checkbox"/>
Hard surface cleaner FRV 30 Me								
Suction hose FRV 30 me	6	4.441-040.0						<input type="checkbox"/>
FRV 30 ME	7	2.111-012.0					Surface cleaner with integrated waste water pick-up	<input type="checkbox"/>

■ Included in delivery. □ Available accessories. ▲ Extension hose.

HDS 5/12 C

1.272-902.0



												Order Number						Price	Description		
Nozzle union																					
Protection part TR only for replacement		1	4.112-011.0																	<input type="checkbox"/>	
Rotary coupling																					
Rotary coupling		2	4.111-021.0																Kärcher rotary coupling prevents twisting and kinking of high-pressure hoses for ease of use. Connector M 22 x 1.5 m. With grip protection.	<input type="checkbox"/>	
Coupling																					
Coupler -2xM22x1,5		3	4.111-037.0																Brass double connector for connecting and extending high-pressure hoses. With rubber protection. Connector: 2x M 22 x 1.5 m.	<input type="checkbox"/>	
Connector																					
Nozzle connector/screw connector		4	4.111-022.0																Nozzle connector/screw connector for connecting high-pressure nozzles and accessories to the high-pressure trigger gun (with nozzle connector). Connectors: 1x M 22 x 1.5 and 1x M 18 x 1.5.	<input type="checkbox"/>	
		5	4.111-038.0																	<input type="checkbox"/>	
Adapter EASY!Lock																					
Adapter 1 M22AG-TR22AG		6	4.111-029.0																	<input type="checkbox"/>	
Adapter 2 M22IG-TR22AG		7	4.111-030.0																	<input type="checkbox"/>	
Adapter 3 M22IG-TR22AG		8	4.111-031.0																	<input type="checkbox"/>	
Adapter M22 - Swivel		9	4.111-032.0																M22 x 1,5female and swivel connection. For extension of high-pressure hoses with AVS connection or for usage of the telescopic lance with a high-pressure hose with AVS connection.	<input type="checkbox"/>	
Adapter 5 TR22IG-M22AG		10	4.111-033.0																	<input type="checkbox"/>	
Adapter 6 TR22IG-M22AG		11	4.111-034.0																	<input type="checkbox"/>	
Adapter 7 M18IG-TR20AG		12	4.111-035.0																	<input type="checkbox"/>	
Adapter 8 TR20IG-M18AG		13	4.111-036.0																	<input type="checkbox"/>	
ADAPTER for replacement TR22IG-M22AG Er		14	4.111-046.0																	<input type="checkbox"/>	
Flue pipe																					
Flue gas adapter		15	4.656-149.0																	Flue gas adapter with draught damper for flue pipe connection (adapter for HDS burners for connection to a stack system).	<input type="checkbox"/>
		16	4.656-080.0																	<input type="checkbox"/>	
HP detergent injector																					
Detergent injector for high and low pressure (without nozzles)		17	4.637-032.0																	Detergent injector for independent high and low pressure dosage. Maximum dosage about 15%.	<input type="checkbox"/>
Detergent injector for high pressure		18	4.637-033.0																	Cleaning agent dosage at high pressure 3 - 5 %	<input type="checkbox"/>
Machine-specific nozzle kit with order no. 3.637-170																					
Nozzle insert trapezoidal thread HDS-GER		19	4.769-009.0																	<input type="checkbox"/>	
Nozzle insert with order no. 3.637-001																					
Nozzle insert for Order No. 3.637-001, high-pressure for machines up to 1100 l/h.		20	4.769-003.0																	Nozzle insert for detergent injector 3.637-001 for high-pressure detergent application. For high-pressure cleaners with a water flow rate up to 1100 l/h.	<input type="checkbox"/>
Low pressure for units rated up to 1100 l/h		21	4.769-001.0																	For low pressure with machines up to 1.100 l/h	<input type="checkbox"/>

■ Included in delivery. □ Available accessories. ▲ Extension hose.

HDS 5/12 C

1.272-902.0



1-5

		Order Number	Nozzle size				Price	Description	
HP nozzle spray angle 0°									
High-pressure nozzle spray angle 0°	1	2.113-001.0	40					High-pressure nozzle with powerful jet for extremely stubborn dirt.	<input type="checkbox"/>
Power nozzle spray angle 15°									
Power nozzle 15034	2	2.113-042.0	34						<input type="checkbox"/>
Power nozzle spray angle 25°									
Power nozzle spray angle 25°	3	2.113-000.0	34					Fan jet nozzle with 25° spray angle, suitable for large areas and removing stubborn dirt and stains.	<input type="checkbox"/>
Nozzle chemical TR for replacement 25250	4	2.113-020.0	250						<input type="checkbox"/>
Power nozzle spray angle 40°									
Power nozzle spray angle 40°	5	2.113-003.0	40					Power nozzle with a 40° spray angle and fan jet, suitable for large areas and sensitive surfaces.	<input type="checkbox"/>

■ Included in delivery. □ Available accessories. ▲ Extension hose.

HDS 5/12 C

1.272-902.0



		Order Number	Nozzle size				Price	Description	
Wet blasting attachment (without nozzle)									
Wet blasting attachment with flow control (without nozzles)	1	4.115-000.0						Paint, rust and scale removal made easy: Kärcher wet blasting attachment with flow control for adding blasting abrasive to the high-pressure jet.	<input type="checkbox"/>
Wet blasting attachment without flow control (nozzles not included)	2	4.115-006.0						Paint, rust and scale removal made easy: Kärcher wet blasting attachment with flow control for adding blasting abrasive to the high-pressure jet. Without flow control.	<input type="checkbox"/>
Nozzle pack for wet blasting attachment									
Nozzle pack TR wet jet set 0035	3	2.112-021.0	35						<input type="checkbox"/>
Nozzle kit for wet blasting attachment 035	4	2.638-526.0	30					Nozzle kit with wet blasting nozzle and nozzle insert (type specific). For optimal Kärcher wet blasting attachment performance. Only in combination with wet blasting attachment 4.762-010/-022.	<input type="checkbox"/>
Boron carbide nozzle									
Boron carbide nozzle, for machines as of 1000 l/h	5	6.415-084.0	6 mm					In addition to nozzle packs. Very wear-resistant nozzle with boron carbide chuck for continuous-duty operation.	<input type="checkbox"/>

■ Included in delivery. □ Available accessories. ▲ Extension hose.

HDS 5/12 C

1.272-902.0

KÄRCHER



1-3



4



5



6



7-8



9



10



11-13

		Order Number	Max. working pressure	Nozzle size	Diameter		Price	Description	
Pipe cleaning hose, ID 6									
Hose assembly TR pipe cleaning DN6 max.2	1	6.110-046.0	250 bar						<input type="checkbox"/>
Pipe cleaning hose, DN 6, 20 m, 220 bar	2	6.110-008.0	250 bar					20 m flexible high-pressure hose (DN 6) for cleaning pipes up to 220 bar (threaded connection for R 1/8 nozzle).	<input type="checkbox"/>
Hose assembly TR pipe cleaning DN6 max.2	3	6.110-047.0	250 bar						<input type="checkbox"/>
Pipe cleaning nozzle									
Dirt blaster pipe cleaning D21/040	4	4.765-001.0		40	21 mm				<input type="checkbox"/>
Dirt blaster pipe cleaning D30/040	5	4.765-004.0		40	30 mm				<input type="checkbox"/>
Nozzle pipe cleaning size 120	6	5.763-089.0		120	24 mm			Pipe cleaning nozzle with 24 mm diameter. With 8 nozzles tilted back at a 30° angle.	<input type="checkbox"/>
Pipe cleaning nozzle	7	5.763-015.0		55	16 mm			16 mm pipe cleaning nozzle with internal thread. Various jet directions for environmentally-friendly cleaning of blocked drains and pipes.	<input type="checkbox"/>
	8	5.763-016.0		60	16 mm				<input type="checkbox"/>
	9	5.763-017.0		50	30 mm			30 mm pipe cleaning nozzle with internal thread. Various jet directions for environmentally-friendly cleaning of blocked drains and pipes.	<input type="checkbox"/>
Rotating pipe cleaning nozzle	10	6.415-428.0		50	16 mm			Rotating pipe cleaning nozzle with internal thread and four rotating jets for environmentally-friendly cleaning of blocked drains and pipes.	<input type="checkbox"/>
Drain cleaning dirt blaster D 25/040	11	6.415-944.0		40	25 mm			The forward-tilted rotating pencil jet removes the most stubborn dirt. The three backwards-tilted jets ensure the necessary forward movement, as well as convenient handling.	<input type="checkbox"/>
Drain cleaning dirt blaster D 30/040	12	6.415-946.0		40	30 mm				<input type="checkbox"/>
Drain cleaning dirt blaster D 35/040	13	6.415-948.0		40	35 mm				<input type="checkbox"/>

■ Included in delivery. □ Available accessories. ▲ Extension hose.

HDS 5/12 C

1.272-902.0

KÄRCHER



		Order Number	Flow rate				Price	Description	
Cup foam lance									
Foam lance TR	1	4.112-053.0	350-600 l/h						<input type="checkbox"/>
Packing complete for 6.394-969.0	2	2.112-018.0							<input type="checkbox"/>
Tank grey only for replacement 1L	3	6.414-050.0							<input type="checkbox"/>
Inno Foam Set									
Inno foam kit with detergent injector	4	2.112-000.0						High-pressure foam system with double lance (foam nozzle and high-pressure jet for rinsing). For use with mobile and stationary high-pressure and HDS pressure cleaners for cleaning or disinfection.	<input type="checkbox"/>
Inno foam kit	5	2.112-008.0							<input type="checkbox"/>
Easy Foam Set									
Easy Foam Set with RM injector	6	2.112-010.0						HP foam system for use with HD/HDS units for cleaning and disinfecting. Foam nozzle for connection to lance and HP chemical injector with precision 0-5% metering valve. The machine specific nozzle kit has to be ordered separately.	<input type="checkbox"/>
Easy foam set	7	2.112-011.0							<input type="checkbox"/>
Nozzle kits for Inno/Easy Foam Set									
Nozzle kit 055 z. Inno/Easy Set 500 - 600 l/h	8	2.111-009.0	500-600 l/h					Optimal adaptation to different machine outputs for economic use.	<input type="checkbox"/>
Foam nozzle mounting kit									
Foam nozzle kit	9	2.112-013.0						Foaming agent kit. The foam nozzle is ideal for use in sanitary areas and the food industry and wherever long application times are necessary.	<input type="checkbox"/>

■ Included in delivery. □ Available accessories. ▲ Extension hose.

HDS 5/12 C

1.272-902.0

KÄRCHER

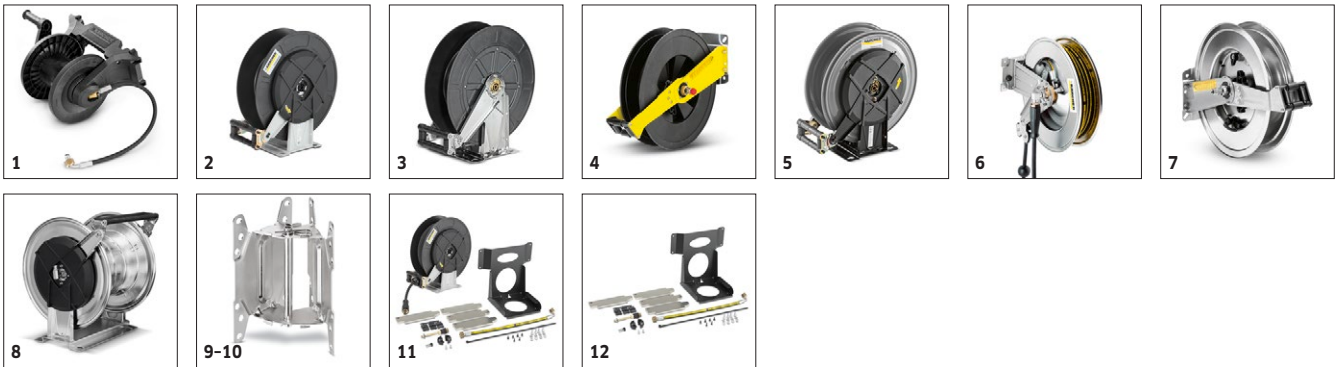

		Order Number	Length				Price	Description	
Hose reel add-on kit									
Hose reel kit, plastic, for HDS 5/12 C - HDS 8/18-4 C	1	2.110-010.0	20 m						<input type="checkbox"/>
Automatic, self-winding hose reels									
Add-on kit hose reel plastics	2	6.392-074.0	20 m					Automatic hose reel for 20 m high-pressure hose. The console is made from powder-coated steel, the drum is made from plastic.	<input type="checkbox"/>
Add-on kit hose reel	3	6.392-083.0	20 m					Automatic hose reel for 20 m high-pressure hose. The console consists of stainless steel, the drum is made from plastic.	<input type="checkbox"/>
Hose reel, automatic, 20 m, painted	4	6.392-106.0	20 m					Automatic hose reel of durable plastic. Painted steel bracket. Suitable for 20 m high-pressure hose.	<input type="checkbox"/>
	5	6.392-105.0	20 m						<input type="checkbox"/>
Hose reel, automatic, 20 m, stainless steel	6	6.392-076.0	20 m					Automatic stainless steel hose reel. With swivel holder. Suitable for 20 m high-pressure hose.	<input type="checkbox"/>
ABS hose reel stainless steel	7	6.392-122.0	20 m					High-grade, automatic steel hose reel. Especially suitable for use in the food industry. The material and finish provide for a corrosion-resistant, watertight capsuled sprong drive. Connection for HP hoses with nipple.	<input type="checkbox"/>
Add-on kit hose reel TR 40m	8	6.392-442.0	40 m						<input type="checkbox"/>
Swivel holder	9	2.639-931.0						Swivel holder for automatic hose reel wall mounting. For maximum action radius and flexibility of high-pressure hose. Rotatable 120°. Galvanised steel.	<input type="checkbox"/>
ABS wall fastening stainless steel	10	2.641-867.0						Swivelling wall bracket made of high-grade steel (for 2.641-866). This makes maximum flexibility and convenience possible when working with the HP hose.	<input type="checkbox"/>
Anbausatz Schlauchtrommel automatik									
Add-on kit automatic hose reel HDS-C	11	2.110-012.0							<input type="checkbox"/>
Add-on kit hose reel	12	2.110-013.0							<input type="checkbox"/>

■ Included in delivery. □ Available accessories. ▲ Extension hose.

HDS 5/12 C

1.272-902.0



		Order Number	Flow rate					Price	Description	
Push-on washing brush										
Push-on washing brush	1	4.762-497.0							With clamp for mounting directly to units' double or triple nozzle. Fits on new double and triple nozzles.	<input type="checkbox"/>
Push-on wash brush, M 18 x 1.5	2	4.113-001.0							Push-on wash brush for universal use. Simply push on to lance. Connector: M 18 x 1.6.	<input type="checkbox"/>
Rotating washing brush										
	3	4.113-004.0	500-800 l/h							<input type="checkbox"/>
	4	4.113-003.0	500-800 l/h							<input type="checkbox"/>

■ Included in delivery. □ Available accessories. ▲ Extension hose.

HDS 5/12 C

1.272-902.0

KÄRCHER



		Order Number	Length	Diameter		Price	Description	
Geka coupling								
With hose nozzle, R 1/2"	1	6.388-461.0					with hose liner	<input type="checkbox"/>
With hose nozzle, R 3/4"	2	6.388-455.0						<input type="checkbox"/>
With hose nozzle, R 1"	3	6.388-465.0						<input type="checkbox"/>
Hose coupling	4	6.388-458.0					with female thread	<input type="checkbox"/>
Suction filter								
Water filter	5	6.414-956.0						<input type="checkbox"/>
Suction filter with check valve	6	4.730-012.0					Brass suction filter suitable for ponds, storage tanks, etc. With check valve.	<input type="checkbox"/>
Fine-mesh water filter								
Fine-mesh water filter with adapter	7	4.730-102.0					Fine-mesh water filter, 125 µm, max. temperature 50°C. Protects the high-pressure cleaner from dirt particles contained in the water. Water flow rate up to 1200 l/h. Connection 3/4", with adapter, 1".	<input type="checkbox"/>
Fine-mesh water filter, 100 µm, R 1"	8	2.638-270.0					Fine-mesh water filter, 100 µm, max. temperature 60°C. Connects to high-pressure cleaner. Protects the high-pressure cleaner from dirt particles contained in the water. Water flow rate up to 1200 l/h. Connector 1".	<input type="checkbox"/>
Water supply hose								
Water supply hose	9	4.440-038.0	7,5 m				NW 13 R1" / R 3/4", up to 30 °C	<input type="checkbox"/>
	10	4.440-207.0	7,5 m				NW 19 R1" / R 3/4", up to 85 °C, for pick-up	<input type="checkbox"/>

■ Included in delivery. □ Available accessories. ▲ Extension hose.